



Solid Core Energy Monitoring Current Transformer Type ECOL09 Series

The ECOL09 series are solid Core energy monitoring current transformers. The CT is small size and low cost



Electrical Specifications

MODEL	INPUT CURRENT	AVAILABLE OUTPUT
ECOL09-05	5 A	OUTPUTS @ 5mA, 10mA, 15mA, 20mA, 33.3mA, 50mA, 100mA, 0.333V, 0.5V, 1V, 2V (can be customized by customer)
ECOL09-10	10 A	
ECOL09-20	20 A	
ECOL09-40	40 A	
ECOL09-50	50 A	



Mechanical Dimensions in mm

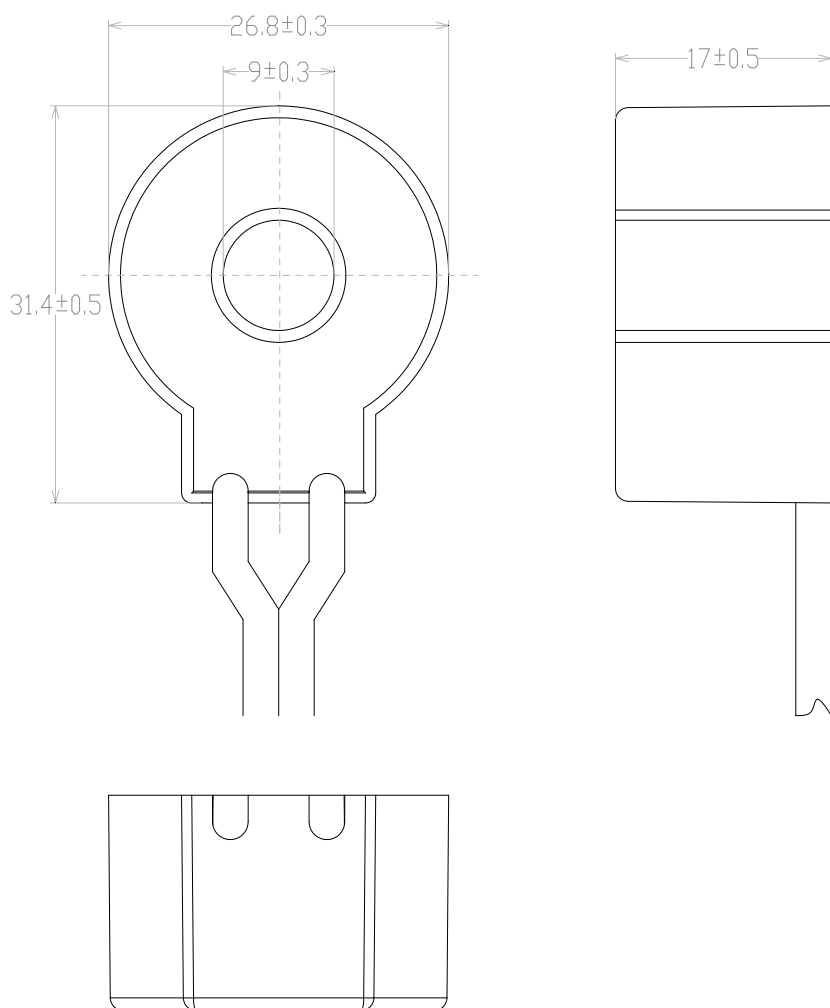

APPLICATIONS

- Energy and sub-metering products
- Electrical load monitoring
- Network equipment
- Instruments and sensors
- Control systems
- Go GREEN initiatives

FEATURES

- 0.354" window opening (ID)
- Custom design Turns-Ratio available
- Rigid housing case with UL 94V-0 durable plastic
- PVC wire leads—18AWG
- UL Listing - UL 2808 / XOBA
- Category III 600V Field Installable
- Up to 2000 meters, PD2
- Approximate weight 60g

SPECIFICATIONS

- Standard Input Current : 0.01-50A
- Frequency 50/60Hz
- Standard accuracy 0.1,0.2,0.5
- Insulation Voltage 5400 Vac/5S
- Operating Temp. -40°C to +70°C
- Storage Temp. -45°C to +85 °C
- ANSI C57.13 and IEC60044-1 Standards
- UL 2808 / XOBA and IEC61010-1 Standards

Connection Diagram

