

The ECH60 series current transformer is compact, smaller than other models with the current ratio of the transformer is small, clamshell-style terminal cover is well protected for the second terminal.



Electrical Specifications

MODEL	INPUT CURRENT	AVAILABLE OUTPUT
ECH60-300	300A	CURRENT OUTPUTS @ 50mA, 100mA, 1A, 5A Voltage OUTPUTS @ 0.333V, 0.5V, 1V, 2V Output can be customized by customer
ECH60-400	400A	
ECH60-500	500A	
ECH60-600	600A	
ECH60-800	800A	
ECH60-1000	1000A	
ECH60-1200	1200A	



Mechanical Dimensions in mm

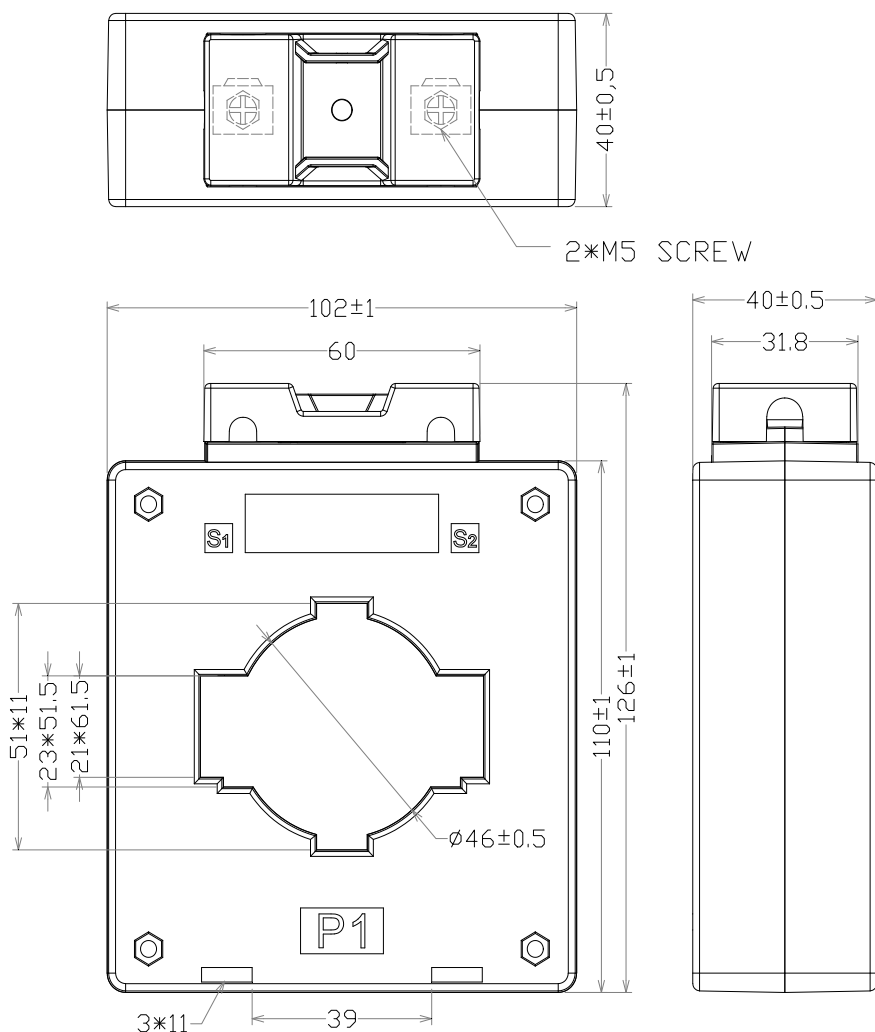

APPLICATIONS

- Energy and sub-metering products
- Electrical load monitoring
- Network equipment
- Instruments and sensors
- Control systems
- Go GREEN initiatives

FEATURES

- 21x61.5 window size
- Custom design Turns-Ratio available
- Rigid housing case with UL 94V-0 durable plastic
- Output Terminal: M5 terminal
- Approximate weight 500g

SPECIFICATIONS

- Standard Input Current 0.5-1200A
- Frequency 50Hz/60Hz
- Standard accuracy 0.1, 0.2, 0.5, 1, 3
- Insulation Voltage 4000 Vac/1min
- Operating Temp. -40°C to +65°C
- Storage Temp. -45°C to +85°C
- ANSI C57.13 and IEC61869-2 Standards

Connection Diagram

